

PIER CAPS

- Used to cap masonry columns, pillars, mailboxes and more
- Flat pier caps present the opportunity to add elements such as spheres, finials or lighting

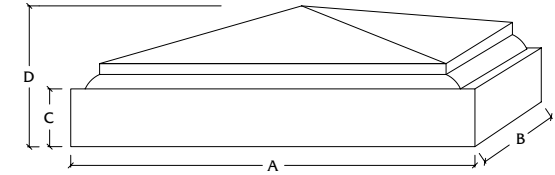
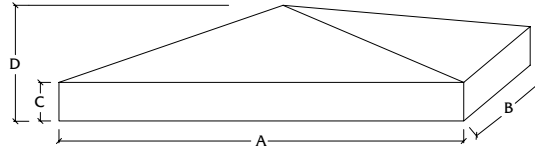

	A	B	C	D
PYC-25-17	17"	25"	4"	10"
PYC-18	18"	18"	2 1/2"	10"
PYC-21	21"	21"	2"	6"
PYC-24	24"	24"	1 5/8"	6 5/8"
PYC-24A	24"	24"	3"	12"
PYC-25	25"	25"	4"	10"
PYC-28	28"	28"	4"	11 1/2"
PYC-28A	28"	28"	2"	10"
PYC-30	30"	30"	4"	13"
PYC-32	32"	32"	2"	15 5/8"
PYC-32A	32"	32"	4"	16 1/2"
PYC-32B	32"	32"	3"	12"
PYC-36	36"	36"	3"	15"

	A	B	C	D
JPYC-18	18"	18"	2"	4 1/4"
JPYC-24	24"	24"	4"	9 1/2"
JPYC-28	28"	28"	4"	8 3/4"
JPYC-32	32"	32"	3 3/4"	8"
JPYC-36	36"	36"	4"	9 3/4"
JPYC-40	40"	40"	4"	10 1/2"
JPYC-48	48"	48"	4"	10"

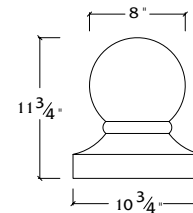
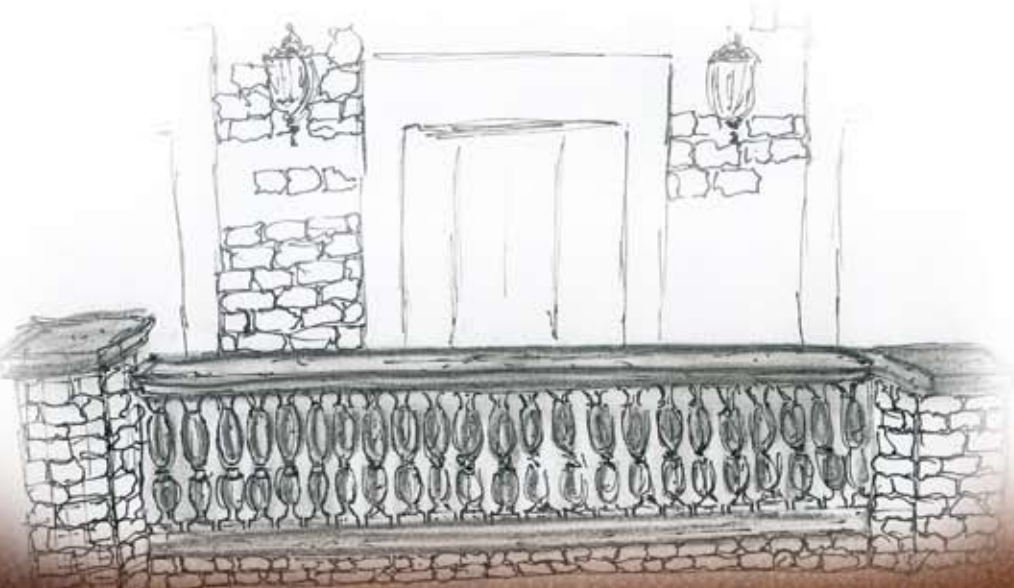

SB-8

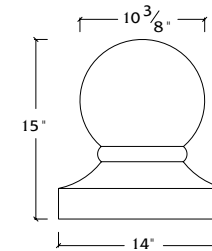

SB-11

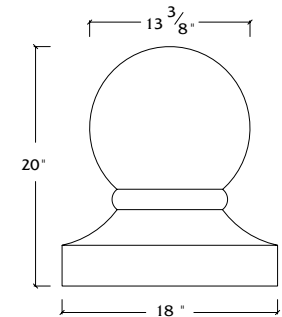

SB-14

PIER CAPS

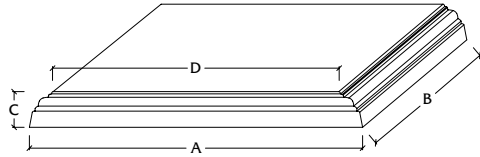

	A	B	C	D
PC-15	14 3/4"	14 3/4"	2 1/2"	12"
PC-18	18"	18"	2 1/2"	15"
PC-24	24 1/4"	24 1/4"	2 5/8"	21"



	A	B	C	D
PC-27	27"	27"	2 1/8"	23 3/4"
PC-28	28"	28"	3 1/8"	25"
PC-32	32"	32"	3 1/8"	29"
PC-36	36"	36"	3 1/4"	33"

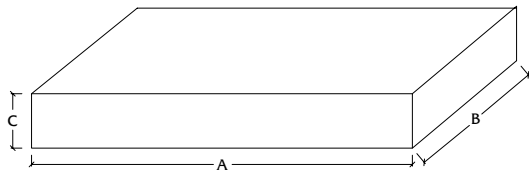

	A	B	C
FC-20-4	20"	20"	4"
FC-24-4	24"	24"	4"
FC-28-4	28"	28"	4"
FC-32-4	32"	32"	4"
FC-36-4	36"	36"	4"
FC-44-4	44"	44"	4"

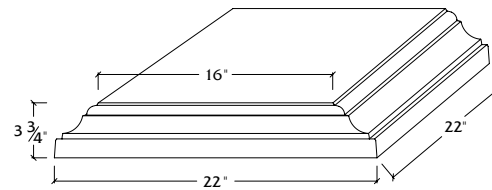

PC-22

